

| REV. | DESCRIPTION | DATE | APPR. |
|------|-----------------|------------|-------|
| 02 | 修改尺寸 Dim B、塑膠高度 | 2010/07/07 | 詹淑梅 |

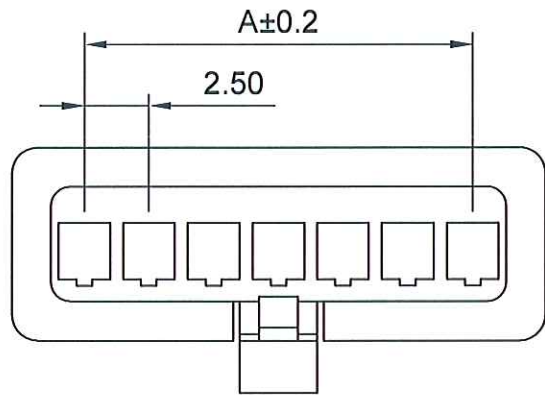

Specifications

Current Rating : 3A AC/DC
 Voltage Rating : 250V AC/DC
 Insulation Resistance : 500 MΩ min.
 Dielectric Withstanding : AC 1000 V
 Operating Temperature : -25°C ~ +85°C
 Insulator Material : Nylon-66, UL 94V-0
 Accepts : 4250A-TM Crimp Terminal
 Mates With 4250A-xxM Series Housing

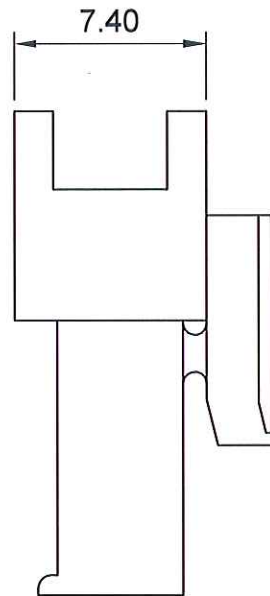
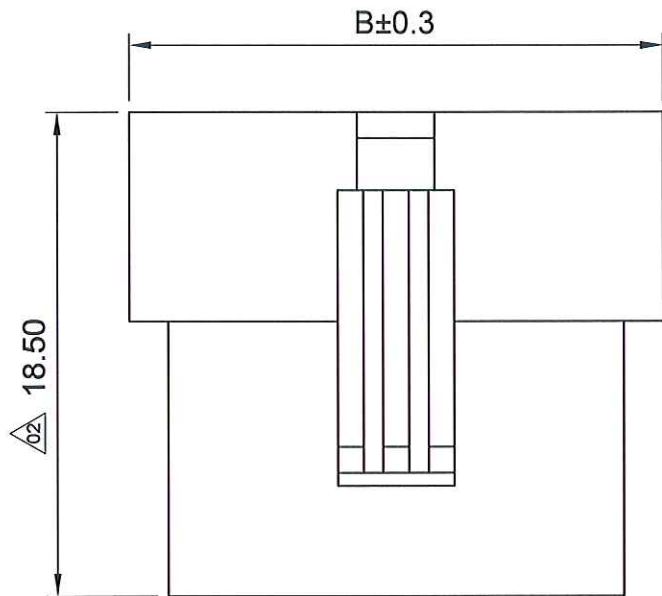

| Part No. | Dimension (mm) | | |
|-----------|----------------|-------|------|
| | A | B | |
| 4250A-02F | 2.50 | 8.10 | △0.2 |
| 4250A-03F | 5.00 | 10.70 | △0.2 |
| 4250A-04F | 7.50 | 13.20 | △0.2 |
| 4250A-05F | 10.00 | 15.70 | △0.2 |
| 4250A-06F | 12.50 | 18.20 | △0.2 |
| 4250A-07F | 15.00 | 20.70 | △0.2 |
| 4250A-08F | 17.50 | 23.20 | △0.2 |
| 4250A-09F | 20.00 | 25.70 | △0.2 |
| 4250A-10F | 22.50 | 28.20 | △0.2 |
| 4250A-11F | 25.00 | 30.70 | △0.2 |
| 4250A-12F | 27.50 | 33.20 | △0.2 |